

CUSTOMER DRAWING

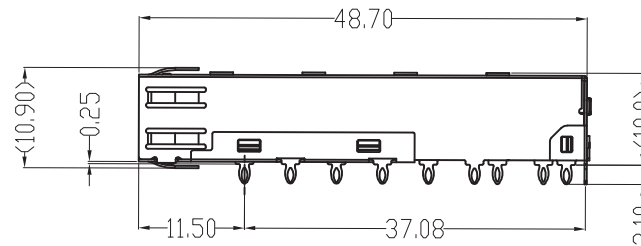
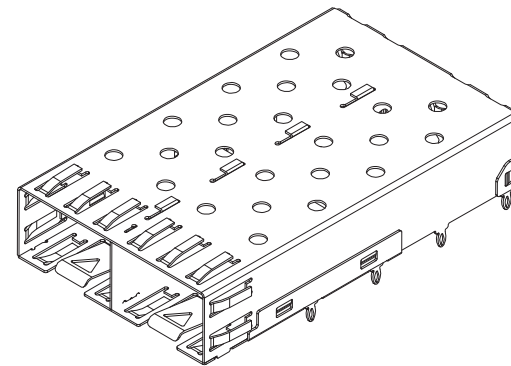
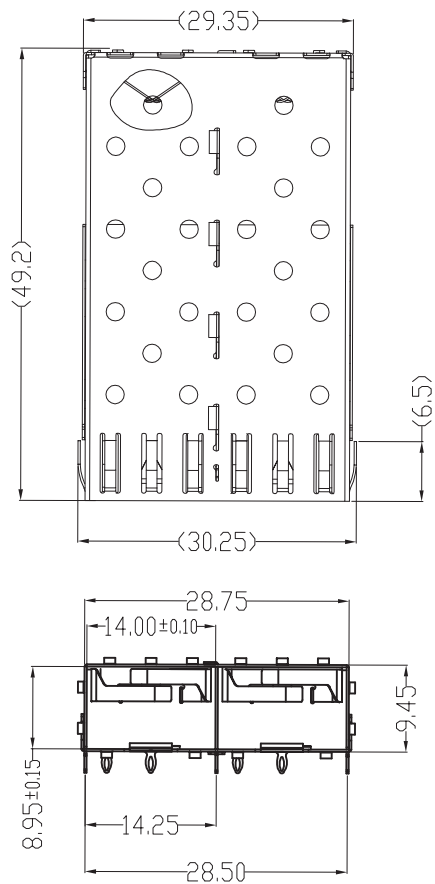

NOTE:

1, DESCRIPTION	Q'ty	MATERIAL	PLATING
SFP TOP CAGE	1PCS	COPPER ALLOY T=0.25	SEE P/N
SFP BOTTOM CAGE	1PCS	COPPER ALLOY T=0.25	SEE P/N
SFP MID CAGE	1PCS	COPPER ALLOY T=0.25	SEE P/N

2, TEMPERATURE:  
 OPERATION: -40°C~+85°C  
 STORAGE: -55°C~+105°C

RoHS Compliant

**VOOHU** 苏州沃虎电子科技有限公司  
 Su Zhou Voohu Electronic Tech.Co.Ltd

TITLE:  
SFP 1X2 CAGE PRESS FIT

SIZE  
A4  
UNITS  
MM[INCH]

GENERAL TOLERANCES  
UNLESS SPECIFIED

APPROVED BY:  
Geoffrey.Song

PART NO.:  
WHSFP00612W003

SACLE  
1:1

REV  
A0

$x \pm 0.35$	$x^\circ \pm 3.0^\circ$
$.x \pm 0.30$	$.x^\circ \pm 2.0^\circ$

CHECKED BY:  
Elvis.Song

REMARK:

SHEET  
1/2

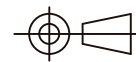

$.xx \pm 0.25$	$.xx^\circ \pm 1.5^\circ$
$.xxx \pm 0.10$	$.xxx^\circ \pm 1.0^\circ$

DESIGND BY:  
Sunny.Xu

TEL: +86 400 1048 018

WEB: WWW.WOHU-TEK.COM

CUSTOMER DRAWING

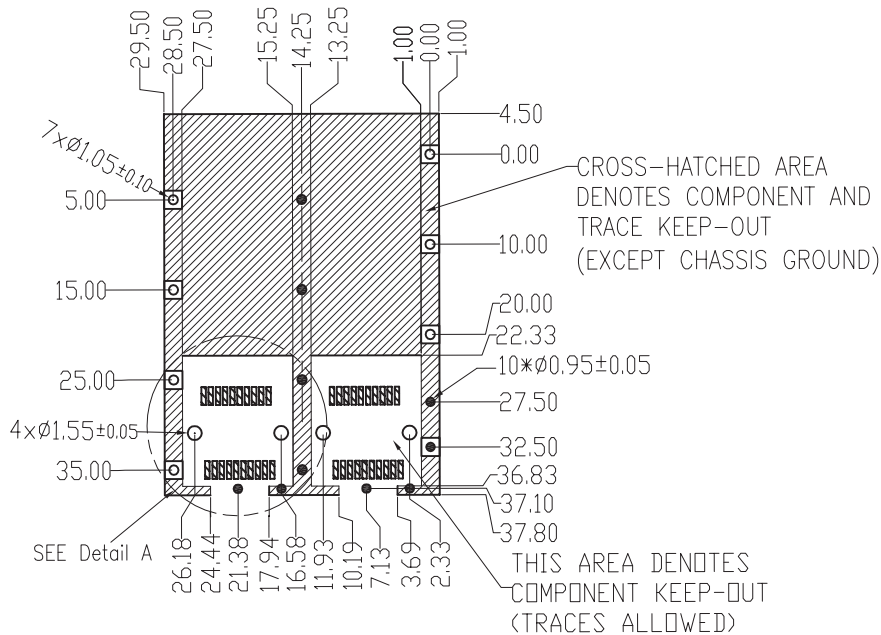
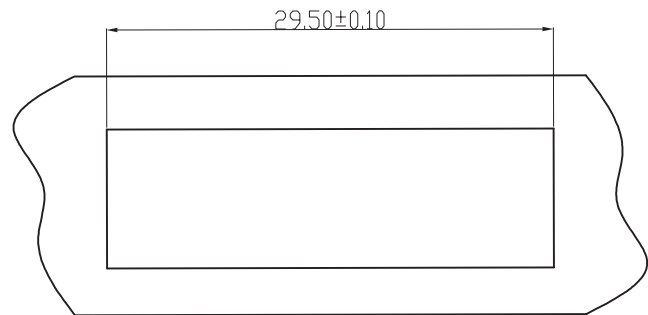

PCB LAYOUT THICKNESS=3.0MM (TOP VIEW)

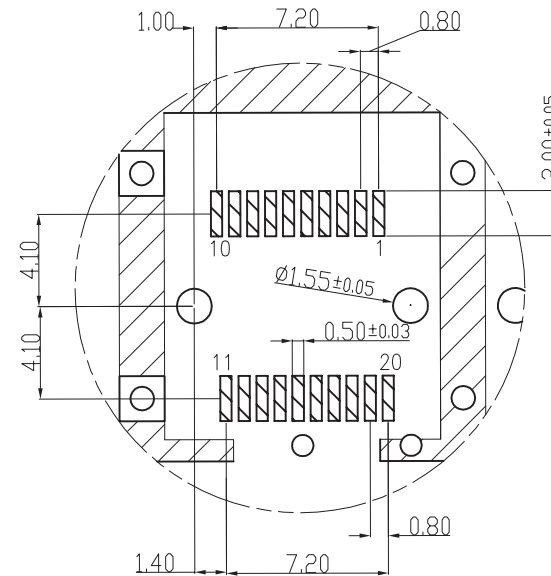
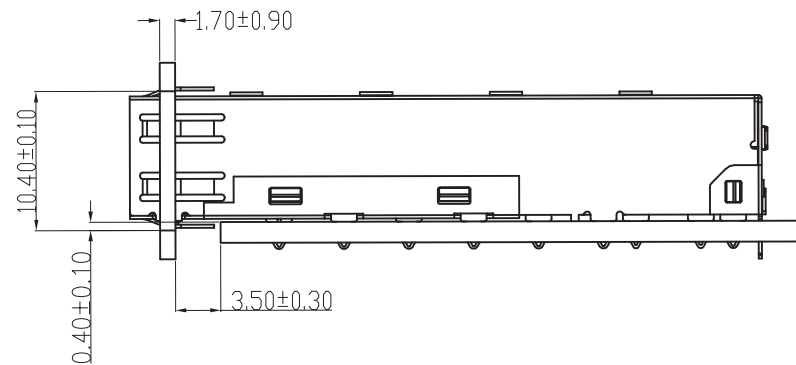

SEE Detail A  
SCALE 2.5:1

RoHS Compliant

**VOOHU** 苏州沃虎电子科技有限公司  
Su Zhou Voohu Electronic Tech.Co.Ltd

TITLE:  
SFP 1X2 CAGE PRESS FIT

SIZE  
A4

UNITS  
MM[INCH]

GENERAL TOLERANCES  
UNLESS SPECIFIED

APPROVED BY:  
Geoffrey.Song

PART NO.:  
WHSFP00612W003

SACLE  
1:1

REV  
A0

$x \pm 0.35$   
 $x^\circ \pm 3.0^\circ$   
 $.x \pm 0.30$   
 $.x^\circ \pm 2.0^\circ$

CHECKED BY:  
Elvis.Song

REMARK:

SHEET  
2/2



$.xx \pm 0.25$   
 $.xxx \pm 0.10$   
 $.xx^\circ \pm 1.5^\circ$   
 $.xxx^\circ \pm 1.0^\circ$

DESIGND BY:  
Sunny.Xu

TEL: +86 400 1048 018

WEB: WWW.WOHU-TEK.COM