

REACH & RoHS  
COMPLIANT

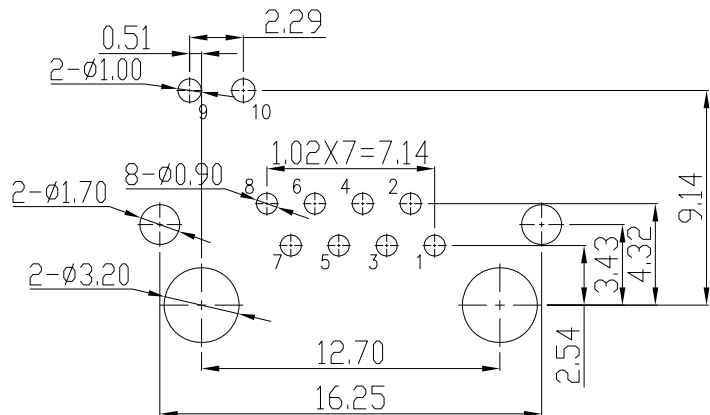

PC Board Layout

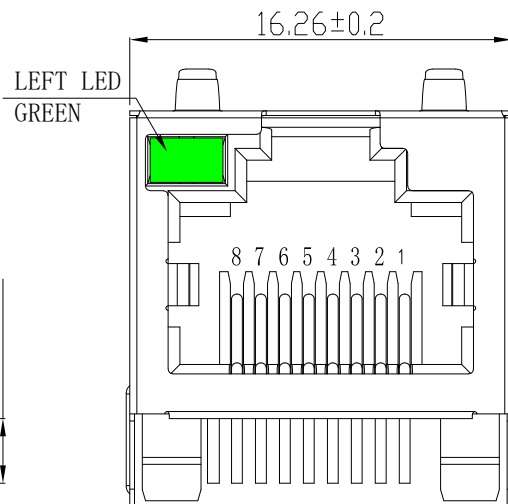
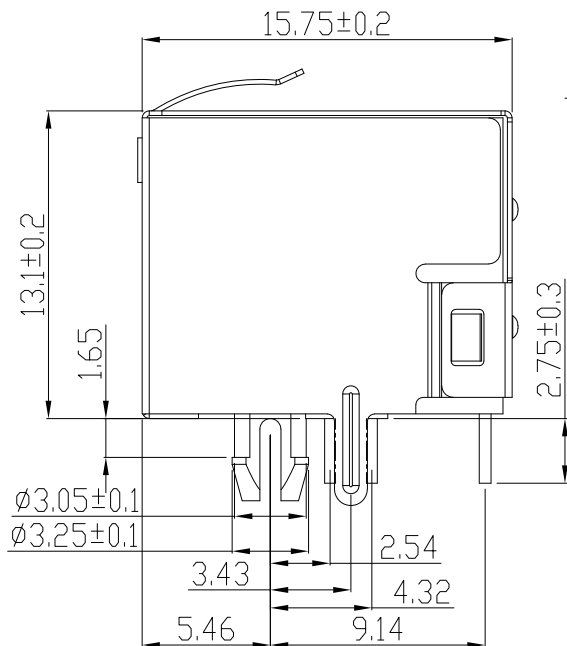
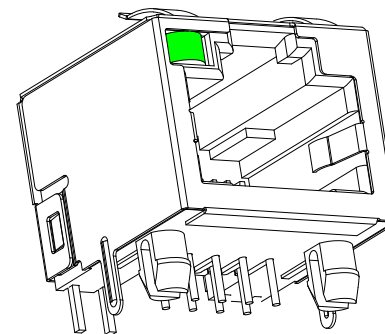
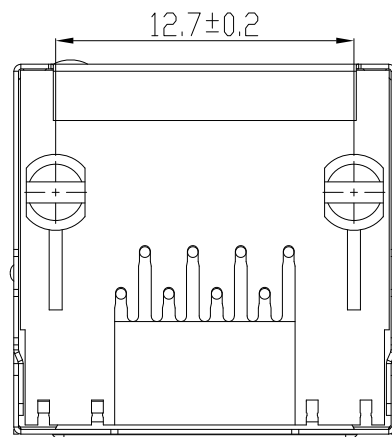

LED L GREEN



NOTES:

ELECTRICAL:

1. VOLTAGE RATING: 125V AC.
2. CURRENT RATING: 1.5A.
3. CONTACT RESISTANCE: 30 mΩ MAX.
4. INSULATION RESISTANCE: 500 MΩ MIN @ 500V DC.
5. DIELECTRIC STRENGTH: 1000V AC 50Hz or 60Hz, 1MIN.

MECHANICAL:

1. INSERT MATERIAL: UL94V-0.
2. CONTACT MATERIAL: Ø0.46mm C51000 (QSn4-0.3) PHOSPHOR BRONZE GOLD PLATING OVER NICKEL.
3. SHIELD: 0.20mm THICKNESS H65Y BRASS NICKEL PLATED.
4. MATING/UNMATING FORCE: 20N Max.
5. RETENTION STRENGTH: 50N pendant 60±5s.
6. OPERATING LIFE: 750 CYCLES MIN.

ENVIRONMENTAL:

1. STORAGE: -40°C ~ +85°C RELATIVE HUMIDITY<70%.
2. OPERATION: -40°C ~ +85°C.

TITLE: 56S 1X1 8P8C EMI  
LED (左绿右无灯)

SIZE  
A4  
UNITS  
MM[INCH]

GENERAL TOLERANCES  
UNLESS SPECIFIED

APPROVED BY:  
Geoffrey.Song

PART NO.:  
WH56A3188C041101

SCALE  
1:1  
REV  
A0

x±0.35  
.x±0.30  
x°±3.0°  
.x°±2.0°

CHECKED BY:  
Elvis.Song

**VOOHU** 苏州沃虎电子科技有限公司  
Su Zhou Voohu Electronic Tech.Co.Ltd

TEL: +86 400 1048 018

WEB: WWW.VOOHU.CN

REMARK:  
上部带弹片

SHEET  
1/1



.xx±0.25  
.xxx±0.10  
.xx°±1.5°  
.xxx°±1.0°

DESIGNED BY:  
Sunny.Xu