

# Specification for Approval

## 产品承认书

Customer:

Customer P/N:

VOOHU P/N:

WHEP13779

Version No.:

V0.1

Description:

EP13

SUZHOU VOOHU Company Approval		Customer Approval (客户承认签章)
<b>DRAWN</b>	Geoffrey.Song	
<b>CHECKED</b>	Sunny.Xu	
<b>APPROVED</b>	Elvis. Song	
日期DATE:2026/5/18		日期DATE: 2026/5/18

Please Return One Copy to Us After Approved,TKs! (承认后请回寄一份,谢谢)



### 1. Physical Dimensions (Unit:mm)

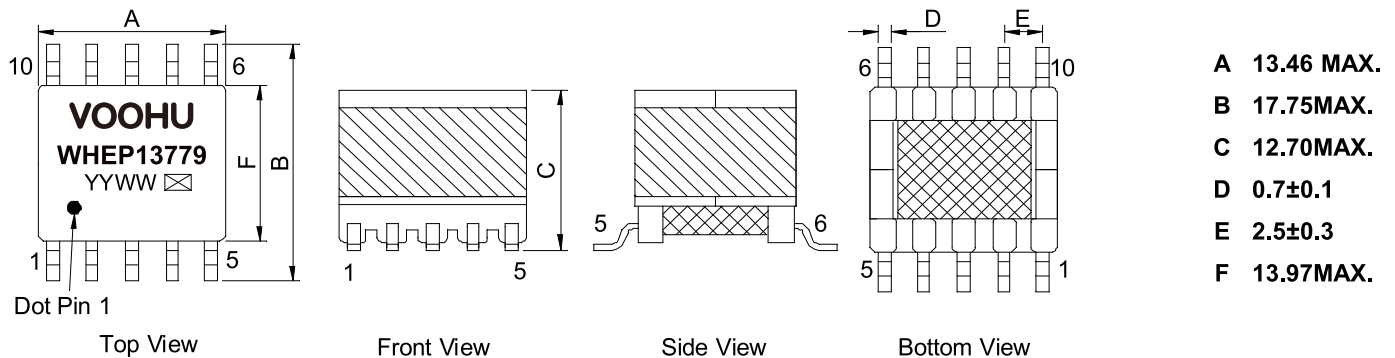

#### Notes:

- (1). Marking type is laser printing
- (2). YY: Year Code; WW: Week Code
- (3). :When making samples, S is used to represent the product is a sample.
- (4). :Use different letters or numbers to represent the products are produced from different production lines .
- (5). Size B not including soldering tags
- (6). Coplanarity Requirement: Less than 0.10mm
- (7). Add epoxy to the center column of the cores

### 2. Connection

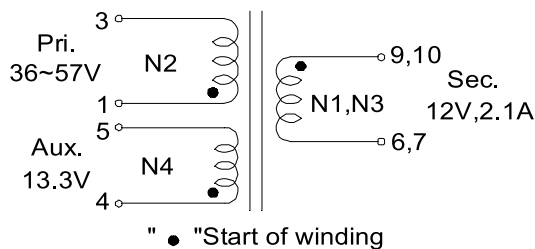

\*Customer to tie terminals 6&7 and 9&10 on PC board.

\*Application of the transformer allows for the leadwires between terminals 6&7 and 9&10 to solder bridge.

### 3. Recommended Pad Layout (Unit:mm)

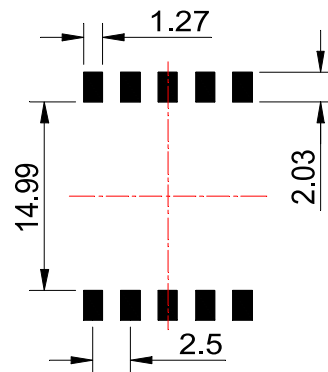

### 4. Structure of Products

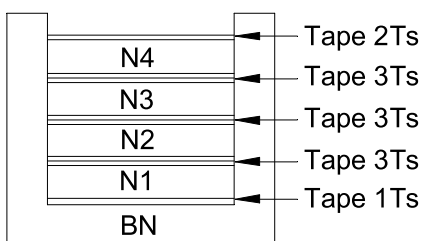

### 5. No of Turns & Wire Spec

No	No of Pin	Turns	Wire Spec
N1	9--6	9 TS	ø0.23mm* 3P P180
N2	1--3	26 TS	ø0.23mm* 2P P180
N3	10--7	9 TS	ø0.23mm* 3P P180
N4	4--5	10 TS	ø0.23mm* 1P P180

DESCRIPTION	PART NO.	REV:R0
EP13	WHEP13779	PAGE:2/5

## 6. Electrical Characteristics

\*Operating temperature range: -40°C to +125°C .

\*Storage temperature range: -40°C to +125°C .

Items	Winding	Specifications	Test Conditions
Inductance	L(1-3)	60uH±10%	at 100kHz,0.1V
LK-Inductance	LK(1-3) Tie other	2uH MAX.	at 100kHz,0.1V
DCR	R(1-3)	180mΩ MAX.	at 25°C
	R(4-5)	190mΩ MAX.	
	R(9,10-6,7)	25mΩ MAX.	
Turns Ratio	(1-3):(4-5):(9,10-6,7)	26:10:9;±3%	at 20kHz,1V
Hi-Pot	Pri. To Sec.	1500VAC	0.5mA.2Sec.
	Win. To Core	500VAC	0.5mA.2Sec.

DESCRIPTION	PART NO.	REV:R0
EP13	WHEP13779	PAGE:3/5

## 7.Recommended Temperature Conditions of Air Reflow Soldering

### Test Solderability Temperature Profile

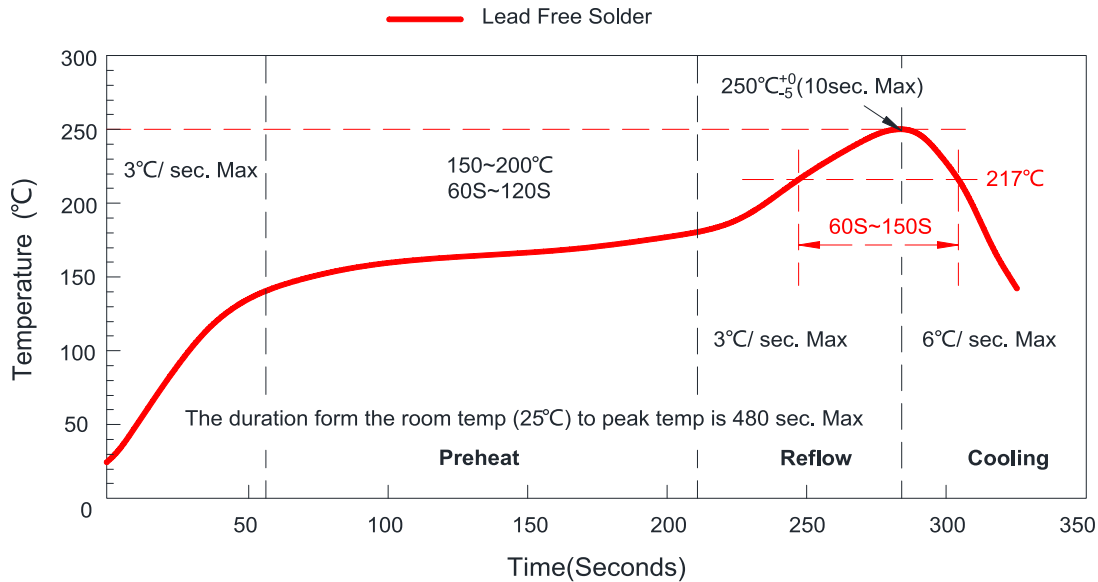

<b>Profile Feature</b>	
Average Ramp-Up Rate (T <sub>max</sub> to T <sub>p</sub> )	3°C/Second Max.
<b>Preheat</b>	
-Temperature Min. (T <sub>min</sub> )	150°C
-Temperature Max. (T <sub>max</sub> )	200°C
-Time (T <sub>min</sub> to T <sub>max</sub> )	60-120 Seconds
<b>Time maintained above:</b>	
-Temperature (T <sub>L</sub> )	217°C
-Time (T <sub>L</sub> )	60-150 Seconds
Peak/Classification Temperature (T <sub>p</sub> )	250°C
Time within 5°C of actual Peak Temperature (T <sub>p</sub> )	10 Seconds Max.
Ramp-Down Rate	6°C/Second Max.
Time 25°C to Peak Temperature	8 Minutes Max.

DESCRIPTION	PART NO.	REV:R0
EP13	WHEP13779	PAGE:4/5

### 8.Packing Request

- \*Every roll of the carrier tape can contain 180pcs products.
- \*Every small packing box contains two rolls of carrier tape. Total quantity: 360pcs.
- \*Every carton box contains 3 small packing boxes. Total quantity: 1080pcs.

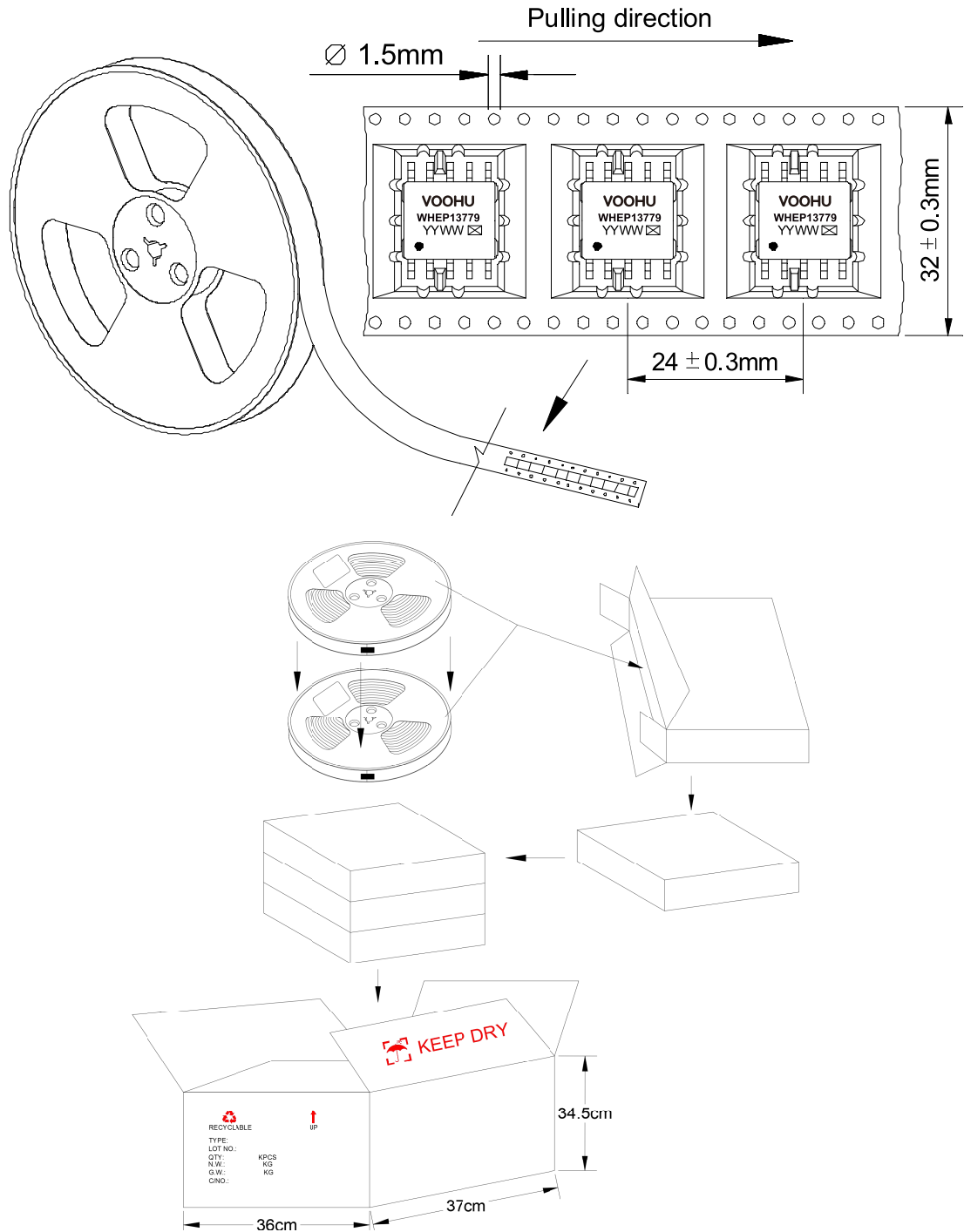

DESCRIPTION	PART NO.	REV:R0
EP13	WHEP13779	PAGE:5/5